

Project Location
 Lat: 27.83543°
 Long: -97.07755°

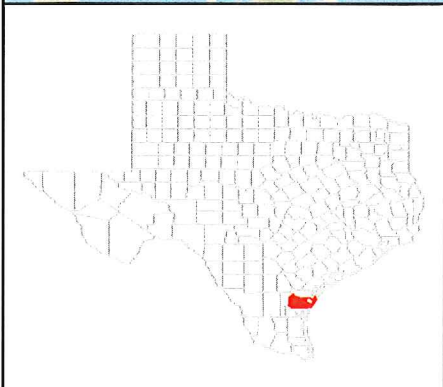

★ Project Location

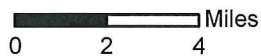

Vicinity Map
Charlie's Pasture Marina Project
City of Port Aransas
Nueces County, Texas

Page 1 of 1

Scale: 1:253,440

NAD83 TX-S ft.

Date: November, 2018

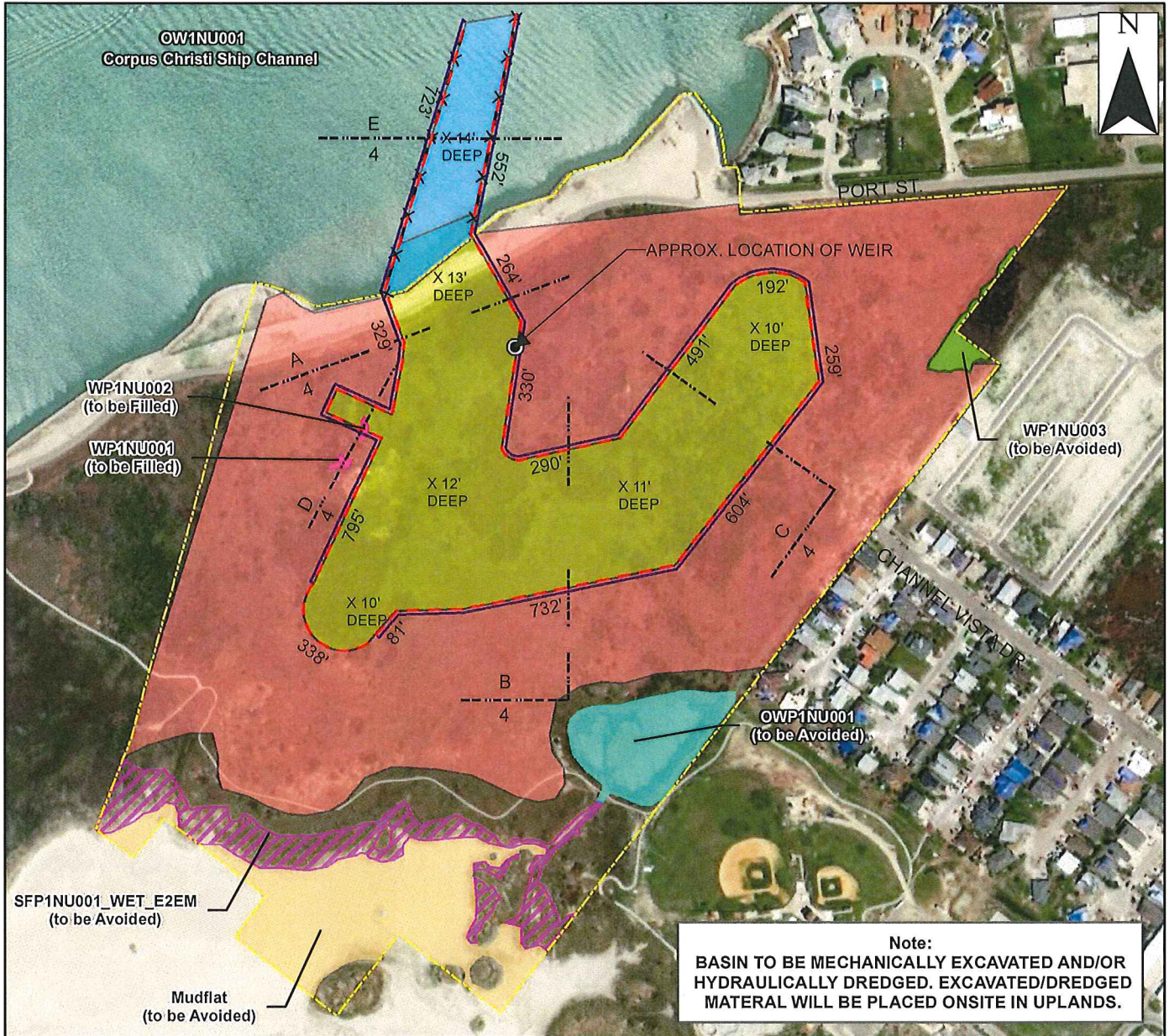

PROPOSED IMPACTS

CONSTRUCTION FOOTPRINT

- ⊙ APPROX LOCATION OF WEIR
- - - BULKHEAD (APPROX. 6052.84 FEET)
- TEMPORARY DIKE (APPROX. 5733.58 FEET)
- - - - CROSS SECTIONAL MARK
- X — STEEL SHEET PILING
- ▭ PROPERTY BOUNDARY
- ◊ PEM WETLAND TO BE FILLED (APPROX. 0.03 ACRES)
- ◻ DREDGED MATERIAL PLACEMENT AREA (APPROX. 38.57 ACRES)
- ◻ PROPOSED EXCAVATED AREA FOR MARINA (APPROX. 15.61 ACRES, 465,500 CY)
- ◻ SHALLOW WATER HABITAT TO BE DREDGED (APPROX. 0.49 ACRES, 10,250 CY)
- ◻ DEEP WATER HABITAT TO BE DREDGED (APPROX 1.86 ACRES, 30,750 CY)

AVOIDED FEATURES

- ◻ E2EM WETLAND (APPROX. 2.63 ACRES)
- ◻ MUDFLAT (APPROX. 4.67 ACRES)
- ◻ PEM WETLAND (APPROX. 0.29 ACRES)
- ◻ WETLAND POND (APPROX. 1.87 ACRES)



**Aerial Plan View Map
Charlie's Pasture Marina Project
City of Port Aransas
Nueces County, Texas**

Page 1 of 1

Scale: 1:4,800

NAD83 TX-S ft.

Date: September, 2019

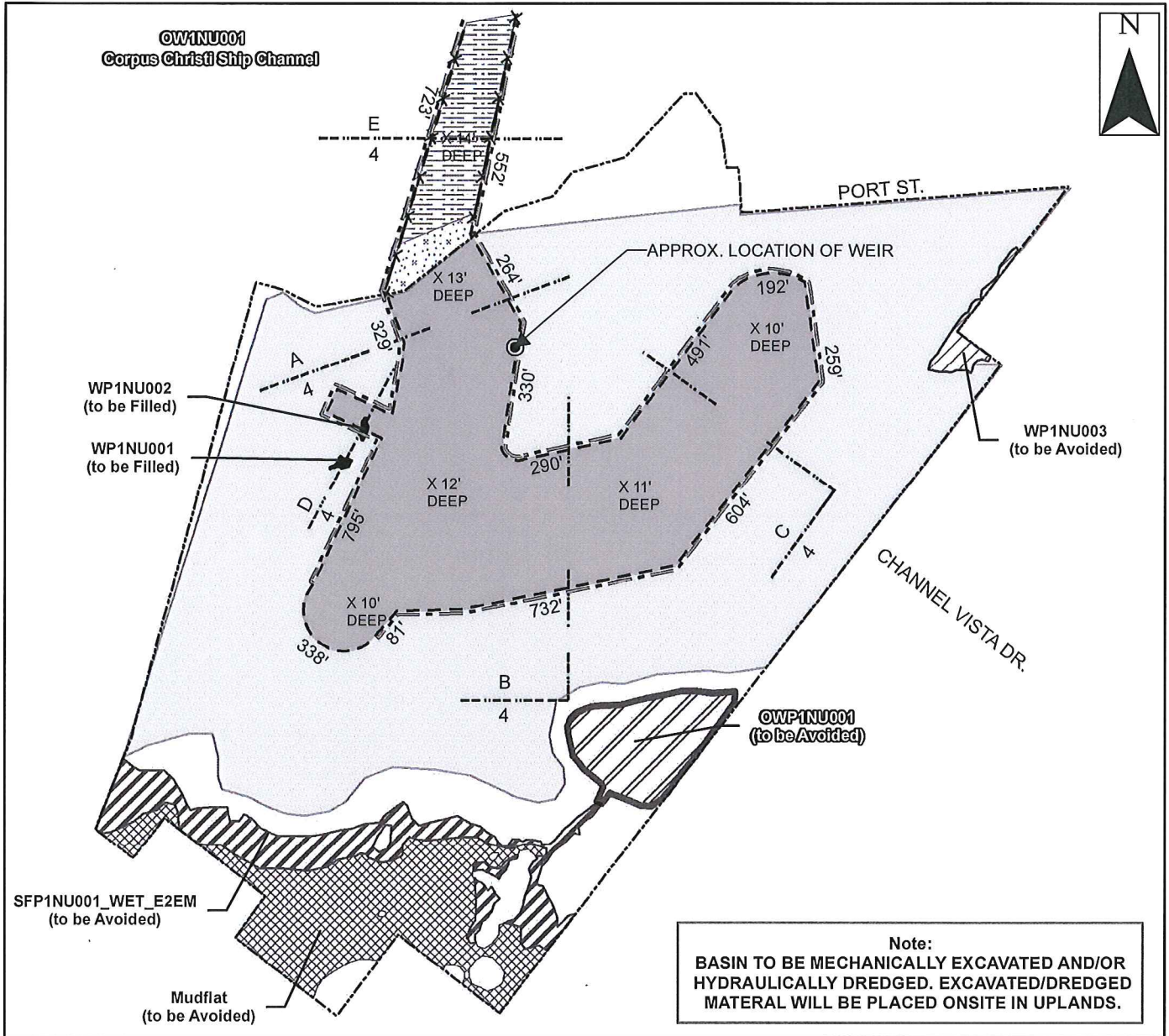

PROPOSED IMPACTS

CONSTRUCTION FOOTPRINT

- APPROX LOCATION OF WEIR
- - - BULKHEAD (APPROX. 6052.84 FEET)
- · - · - TEMPORARY DIKE (APPROX. 5733.58 FEET)
- · - · - CROSS SECTIONAL MARK
- X - STEEL SHEET PILING
- PROPERTY BOUNDARY
- PEM WETLAND TO BE FILLED (APPROX. 0.03 ACRES)
- DREDGED MATERIAL PLACEMENT AREA (APPROX. 38.57 ACRES)
- PROPOSED EXCAVATED AREA FOR MARINA (APPROX. 15.61 ACRES, 465,500 CY)
- SHALLOW WATER HABITAT TO BE DREDGED (APPROX. 0.49 ACRES, 10,250 CY)
- DEEP WATER HABITAT TO BE DREDGED (APPROX 1.86 ACRES, 30,750 CY)

AVOIDED FEATURES

- E2EM WETLAND (APPROX. 2.63 ACRES)
- MUDFLAT (APPROX. 4.67 ACRES)
- PEM WETLAND (APPROX. 0.29 ACRES)
- WETLAND POND (APPROX. 1.87 ACRES)



**Black & White Plan View Map
Charlie's Pasture Marina Project
City of Port Aransas
Nueces County, Texas**

Page 1 of 1

Scale: 1:4,800

NAD83 TX-S ft.

Date: September, 2019

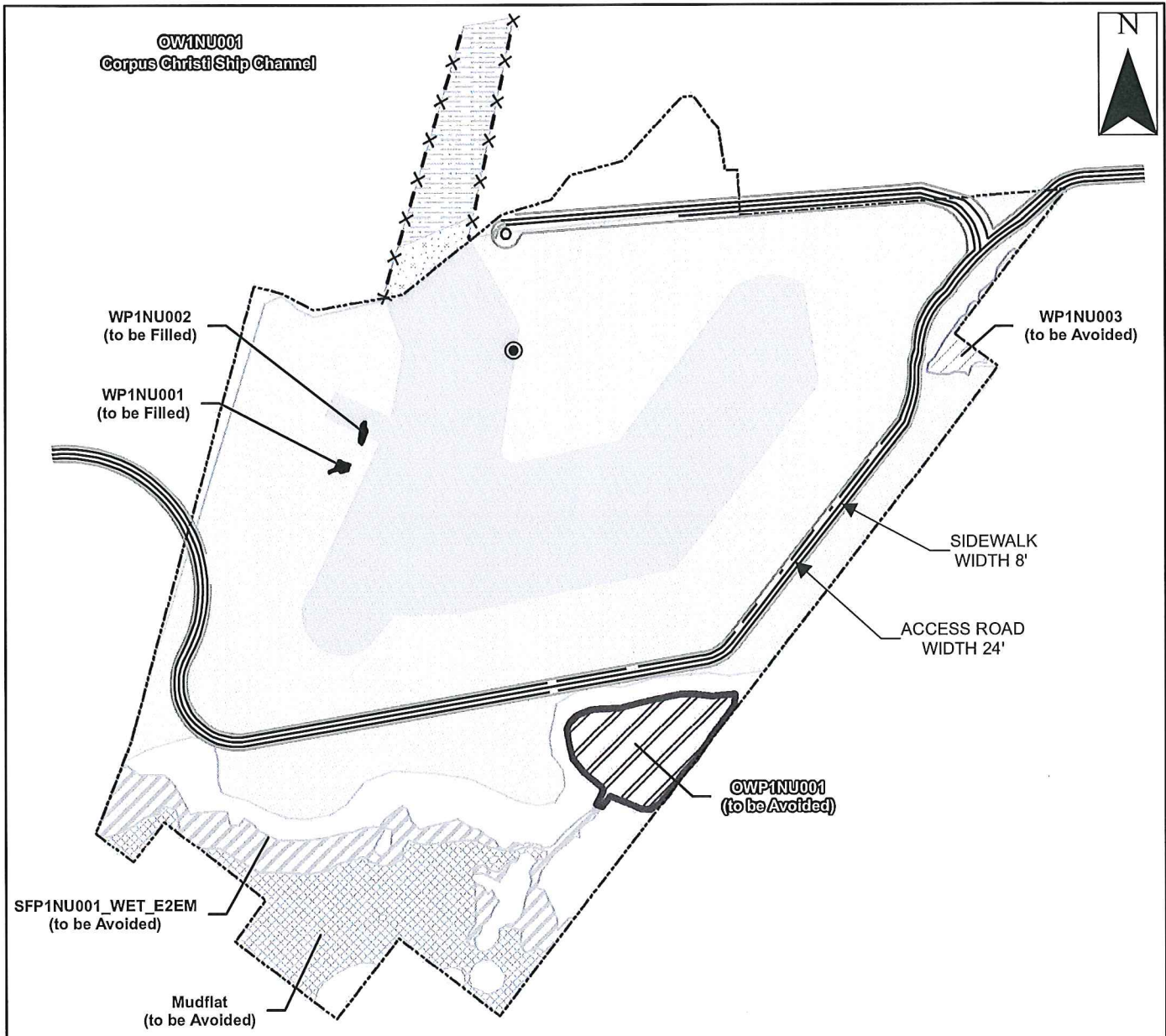

PROPOSED IMPACTS



ACCESS ROAD

- ACCESS ROAD (5,650 FEET , 24 FEET TOTAL WIDTH)
- SIDEWALK (5,650 FEET , 8 FEET TOTAL WIDTH)

AVOIDED FEATURES

- E2EM WETLAND (APPROX. 2.63 ACRES)
- MUDFLAT (APPROX. 4.67 ACRES)
- PEM WETLAND (APPROX. 0.29 ACRES)
- WETLAND POND (APPROX. 1.87 ACRES)

**Access Road Map
Charlie's Pasture Marina Project
City of Port Aransas
Nueces County, Texas**

CORPUS CHRISTI
SHIP CHANNEL

ENTRANCE
CHANNEL

APPROXIMATE
SHORELINE

PORT ST.

CHANNEL VISTA DR.

CONNECT WALKING TRAIL
WITH NEW SIDEWALK.

CONNECT WALKING TRAIL
WITH NEW SIDEWALK.

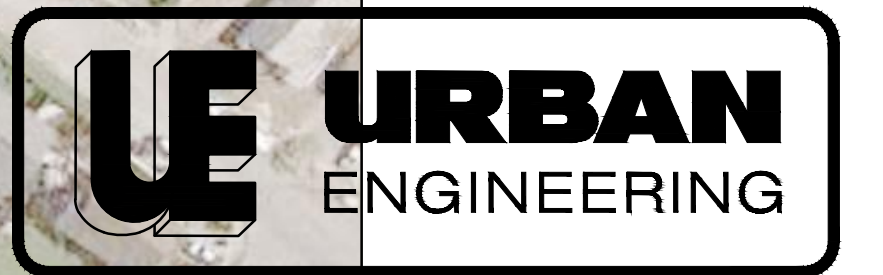

TYPE FIRM NO. 145, TBP'S FIRM NO. 10032400
2725 SWANTNER DR., CORPUS CHRISTI, TX 78404
PHONE: 361.654.8101 WWW.URBANENG.COM

DRAWN: ATH ENG: JLU DATE 09-13-19:
© 2019 by Urban Engineering

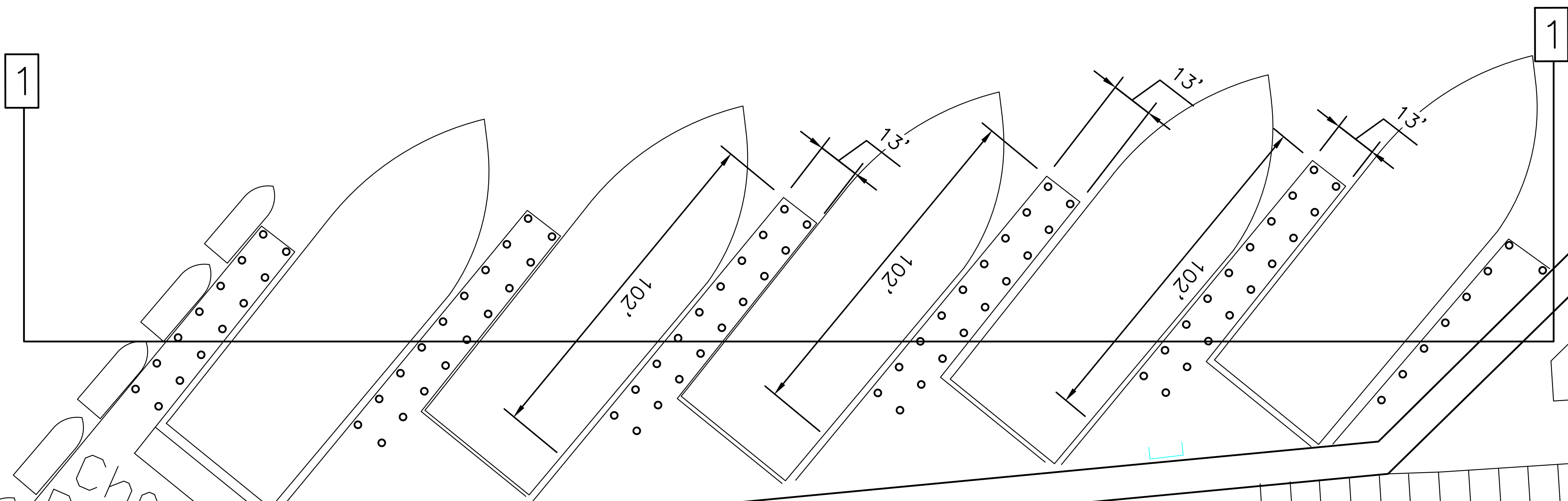
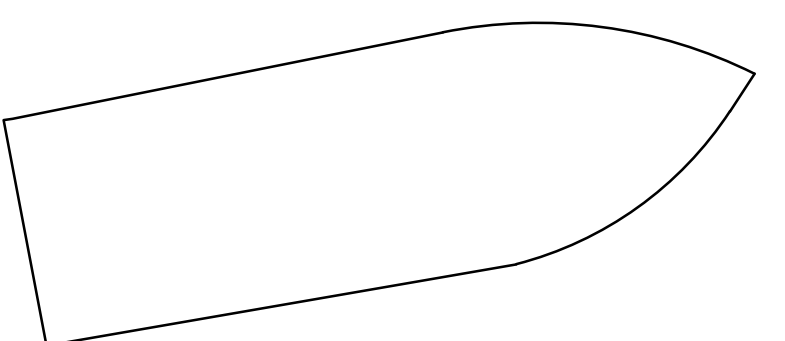
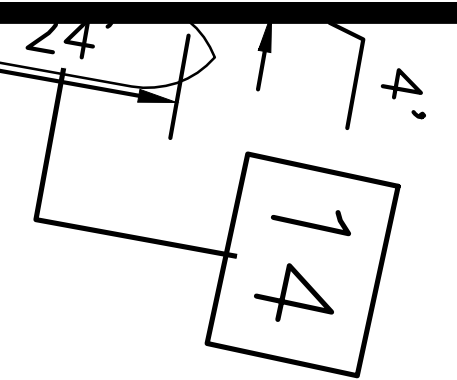

LEGEND:
○ 12" PILING

Charter
Pickupster

2

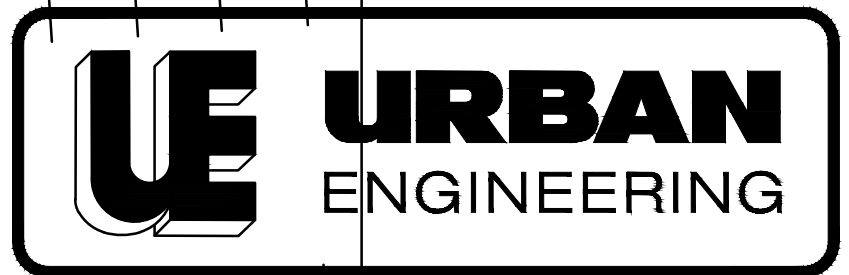
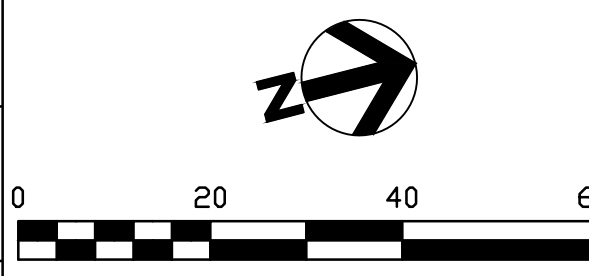

TBPE FIRM NO. 145, TBPLS FIRM NO. 10032400
2725 SWANTNER DR., CORPUS CHRISTI, TX 78404
PHONE: 361.854.8101 WWW.URBANENG.COM

DRAWN: ATH ENG: JULU DATE 09-13-19
© 2019 by Urban Engineering

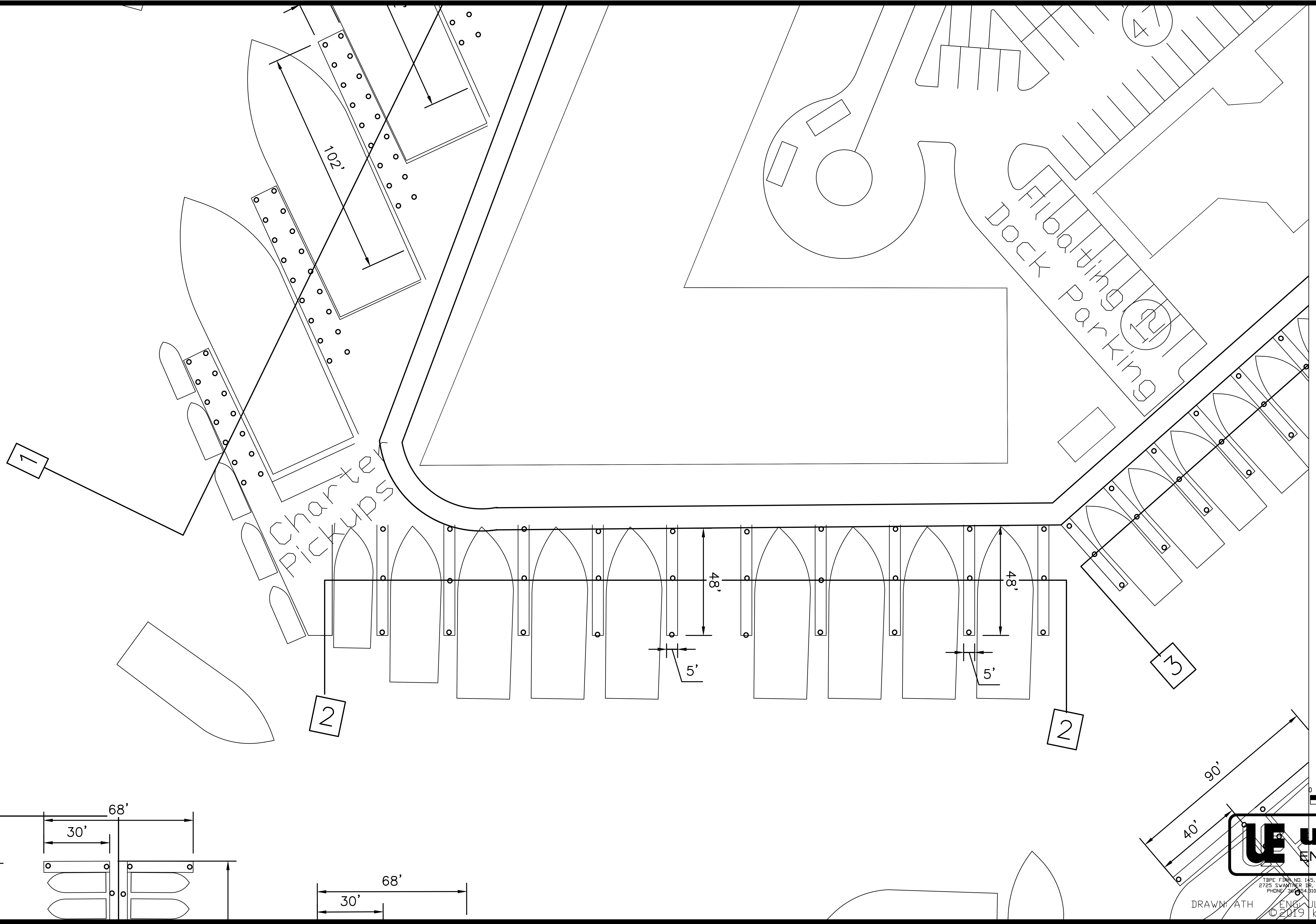

LEGEND:
 ○ 12" PILING

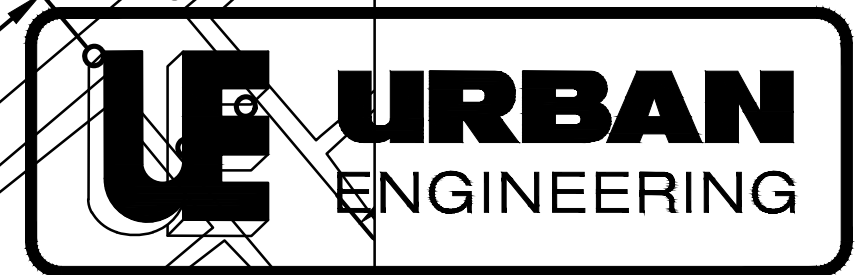
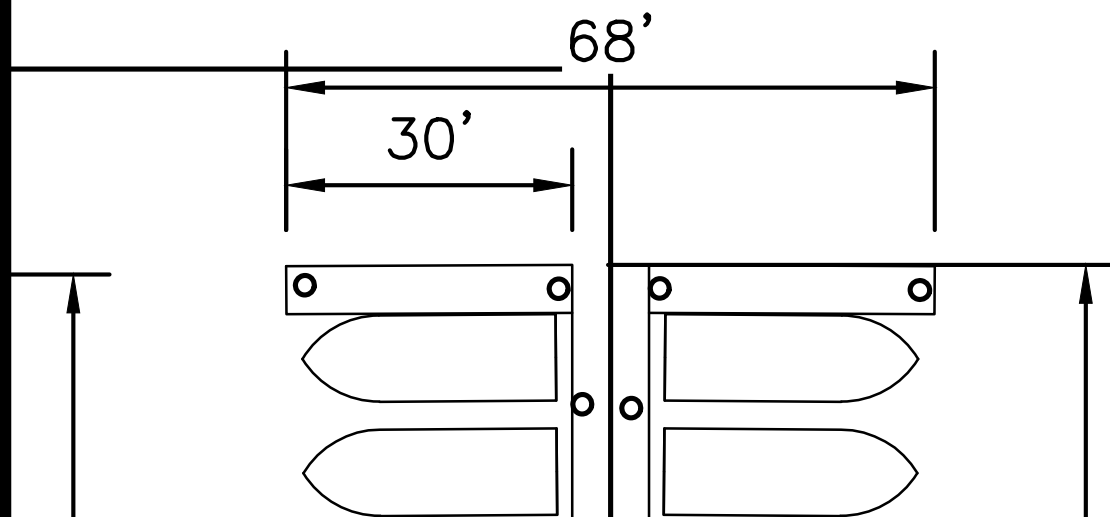

TYPE FIRM NO. 145, TBPLS FIRM NO. 10032400
 2725 SWANTNER DR., CORPUS CHRISTI, TX 78404
 PHONE 361.654.9101 WWW.URBANENG.COM

DRAWN: ATH ENG: JLU DATE: 09-13-19
 © 2019 by Urban Engineering

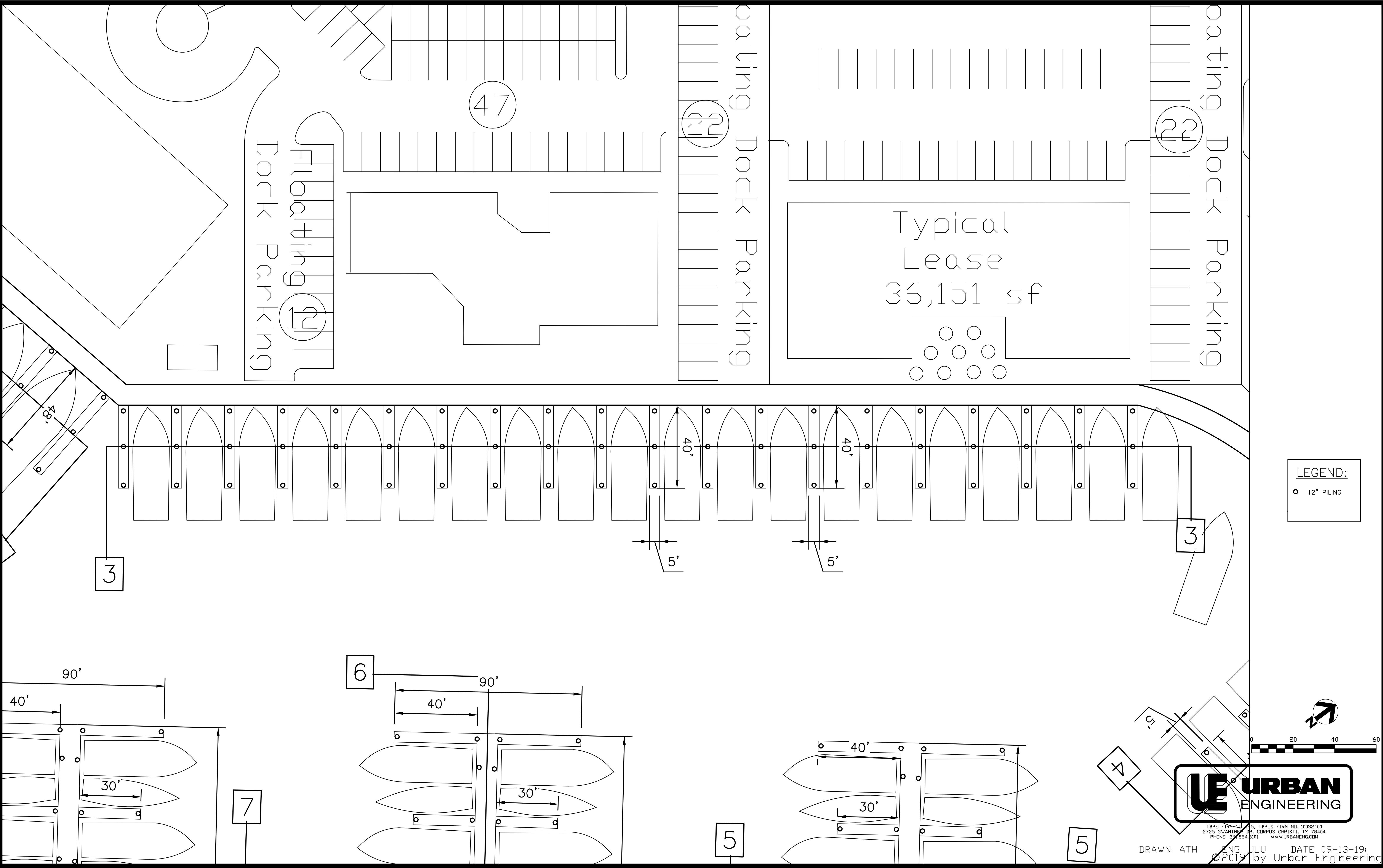

LEGEND:
 ○ 12" PILING

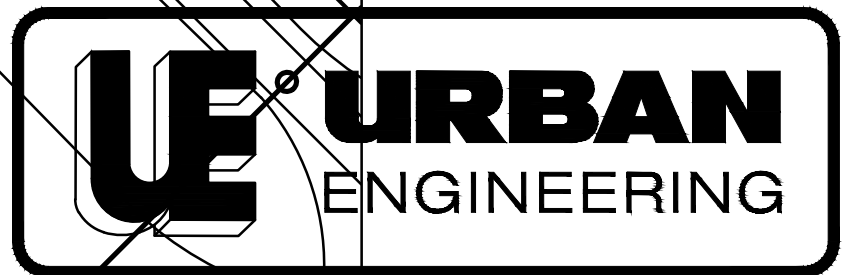

TYPE FIRM NO. 415 TBP&S FIRM NO. 10032400
 2725 SWANTON DR. CORPUS CHRISTI, TX 78404
 PHONE: 361.954.9101 WWW.URBANENG.COM
 DRAWN: ATH ENG: JLU DATE 09-13-19
 ©2019 by Urban Engineering

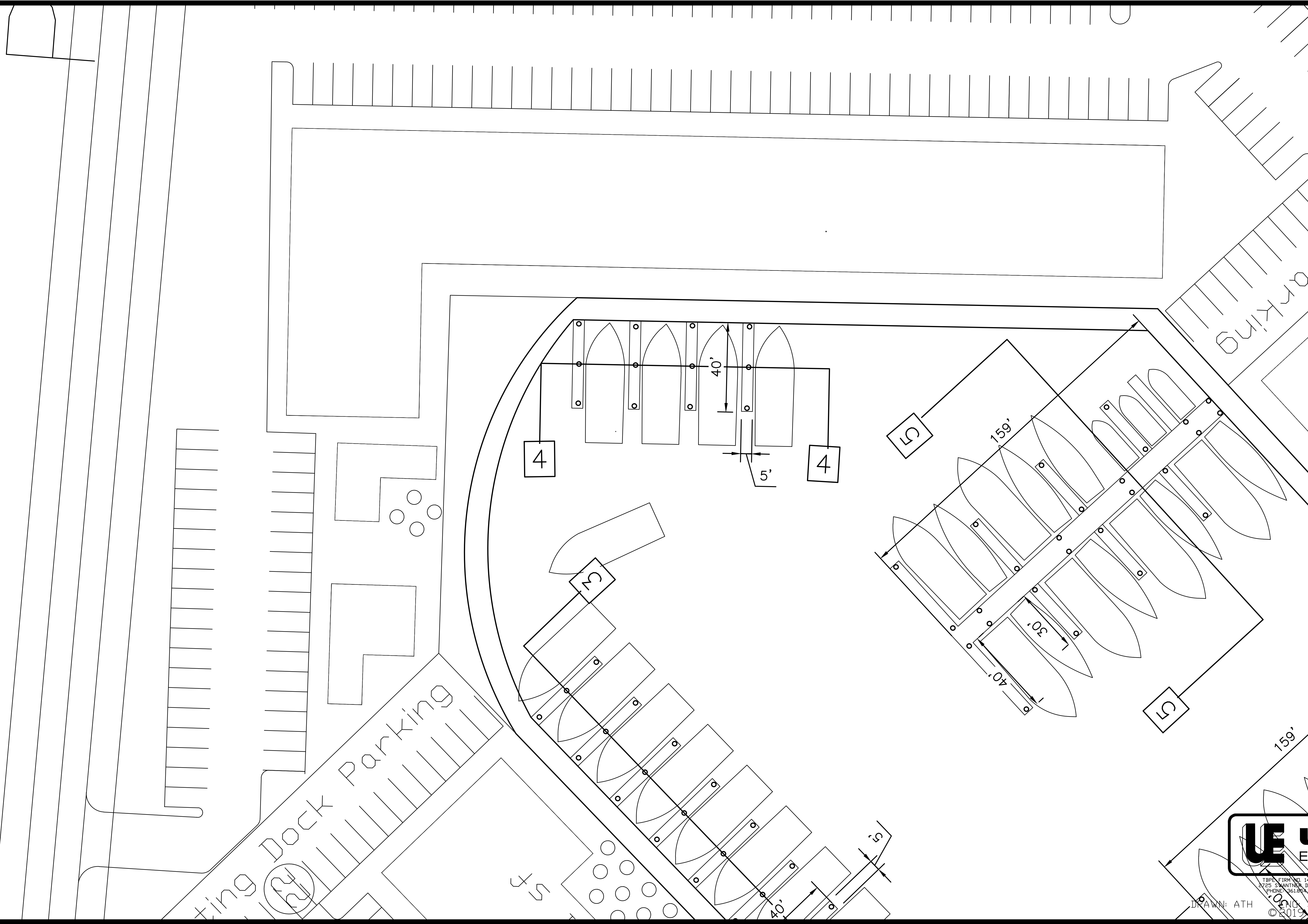

LEGEND:
 ● 12" PILING

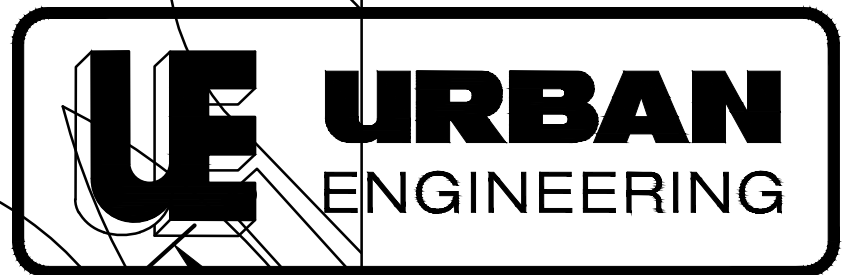

TBPLS FIRM NO. 145 TBPLS FIRM NO. 1002400
 2725 SWANTNER DR. CORPUS CHRISTI, TX 78404
 PHONE 361.968.8101 WWW.URBANENG.COM

DRAWN: ATH
 JULU DATE 09-13-19
 ©2019 by Urban Engineering

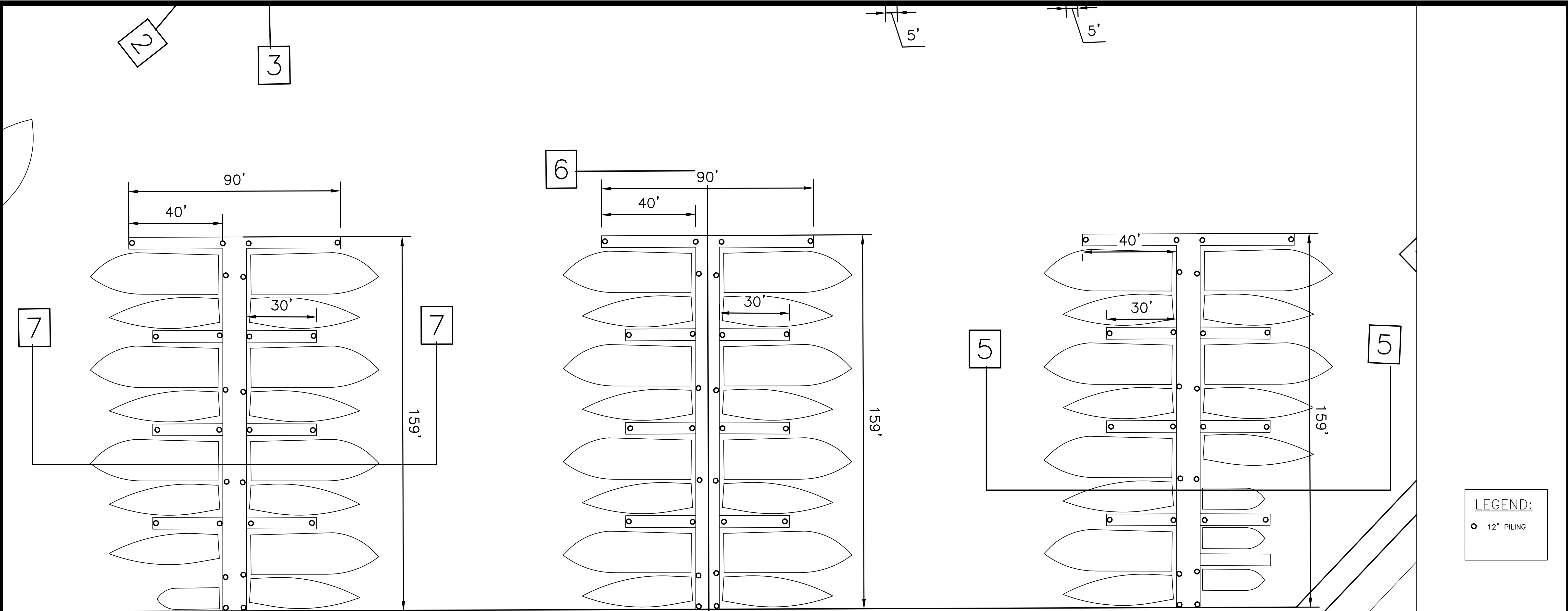

LEGEND:
 ○ 12" PILING

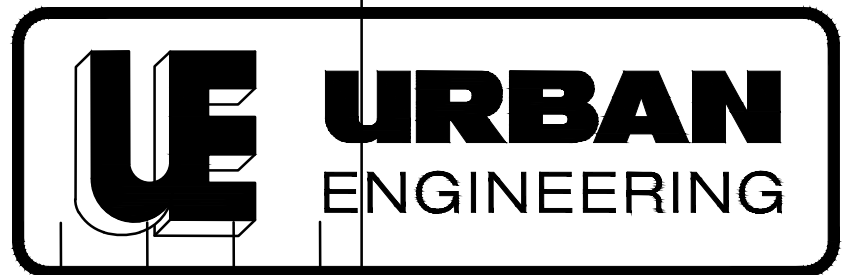
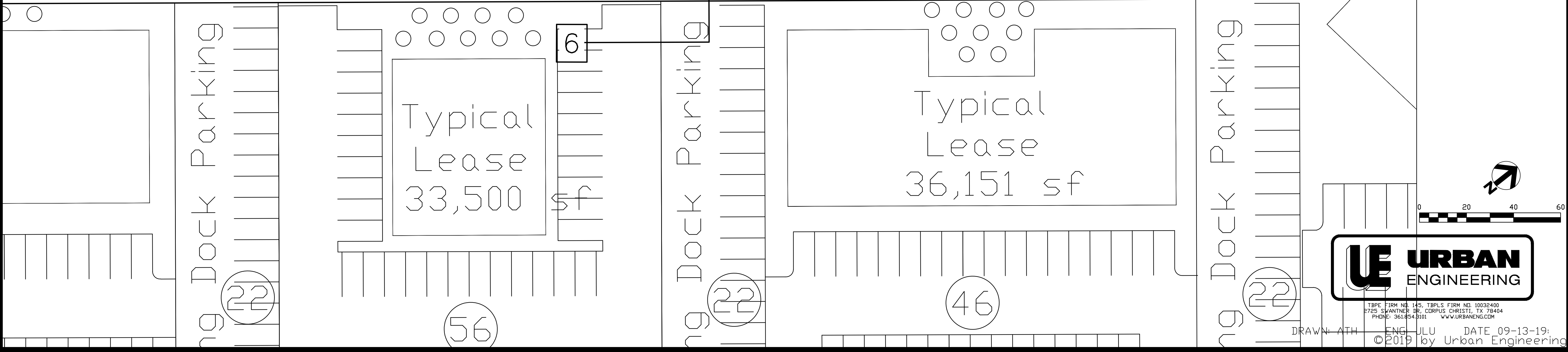

TBPE FIRM NO. 145 TBPLS FIRM NO. 10032400
 2725 SWANTNER DR., CORPUS CHRISTI, TX 78404
 PHONE: 361.954.9101 WWW.URBANENG.COM

DRAWN: ATH ENG: JULU DATE: 09-13-19:
 ©2019 by Urban Engineering

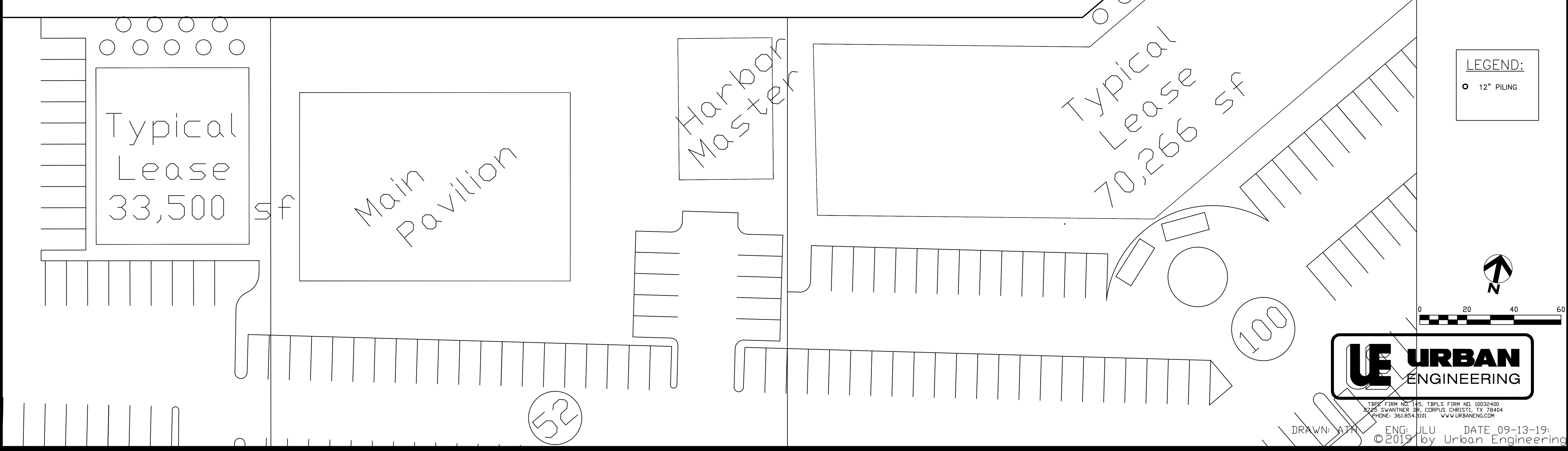
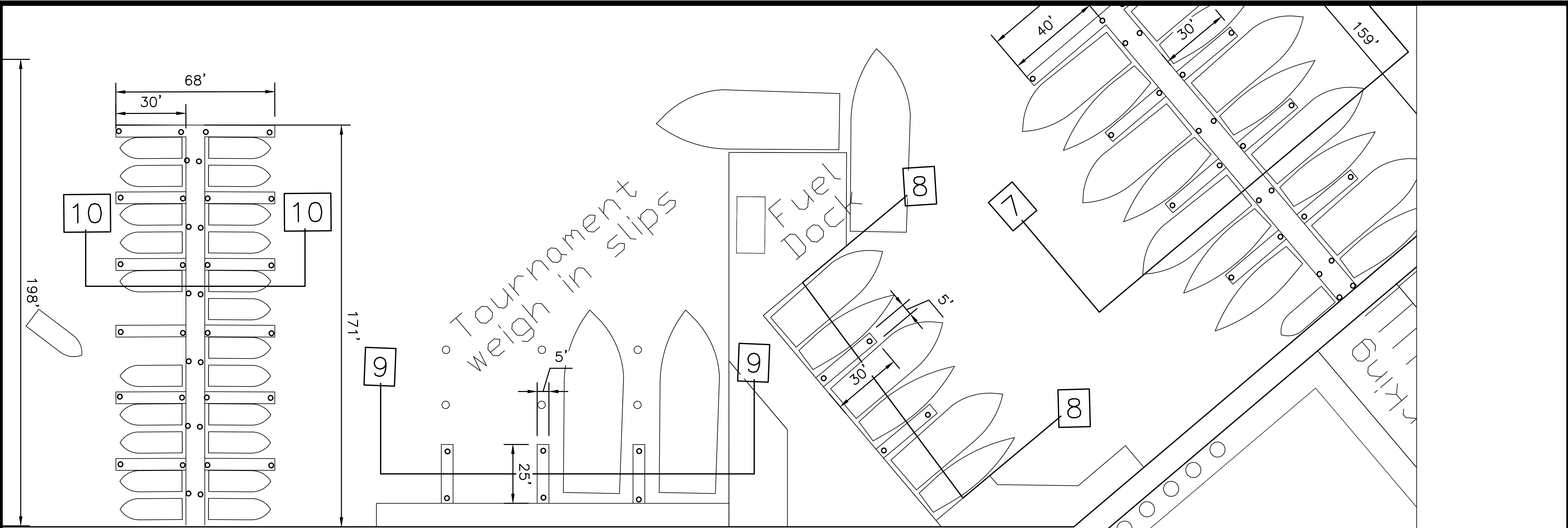

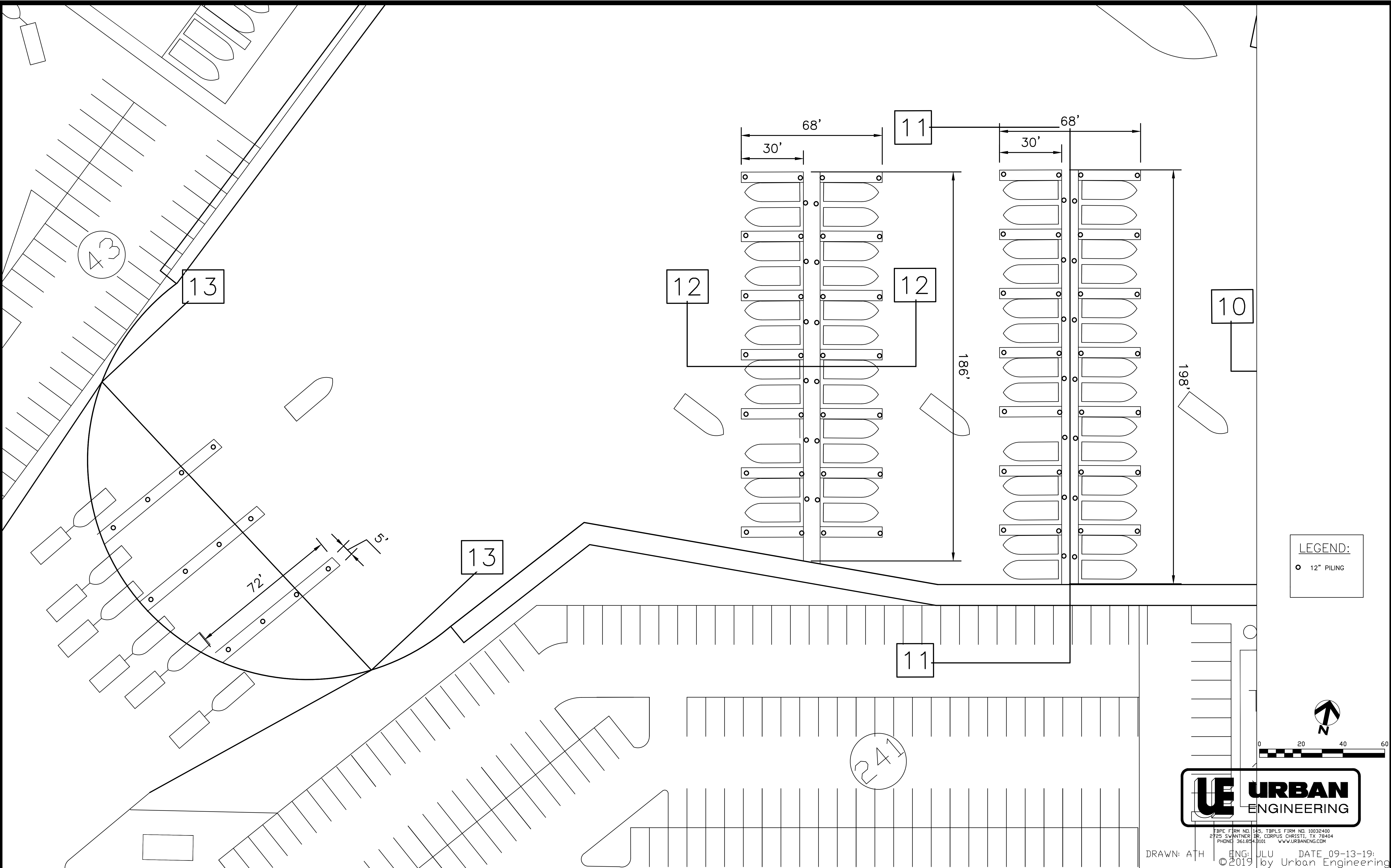

LEGEND:
 ○ 12" PILING

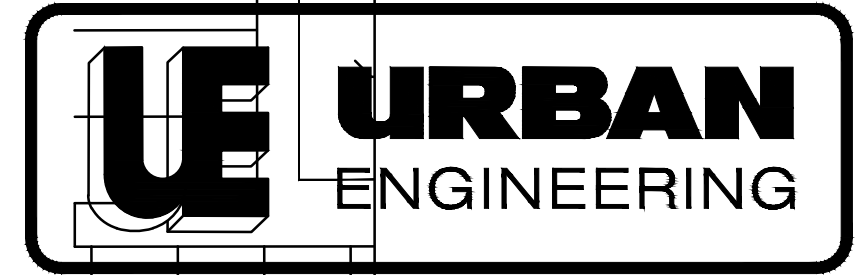

TYPE FIRM NO. 145, TBP&S FIRM NO. 10032400
 2725 SWANTNER DR., CORPUS CHRISTI, TX 78404
 PHONE: 361.854.8101 WWW.URBANENG.COM

DRAWN: ATH ENG: JULU DATE: 09-13-19
 © 2019 by Urban Engineering

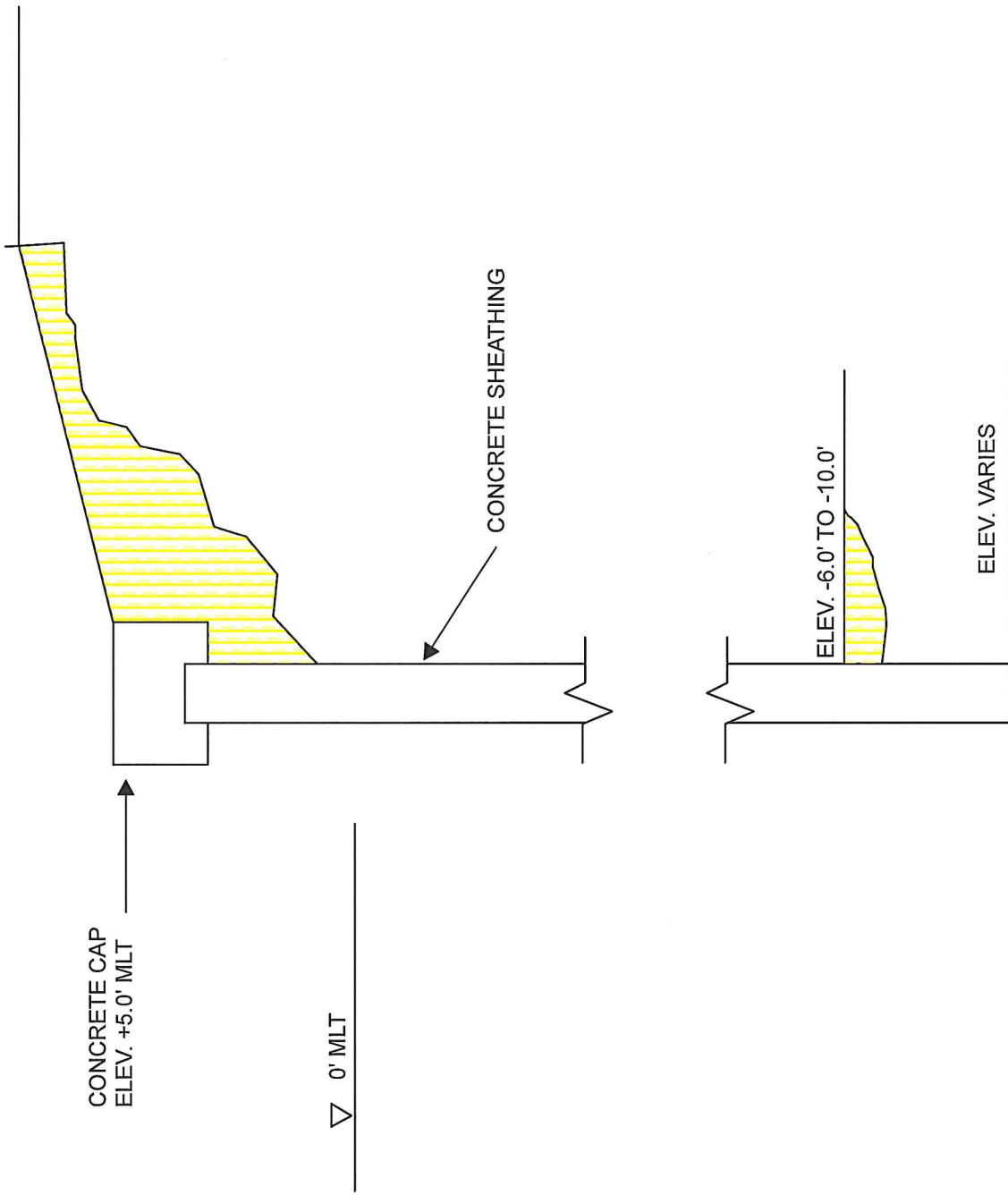

TYPICAL BULKHEAD DETAIL

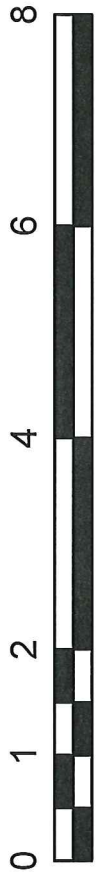

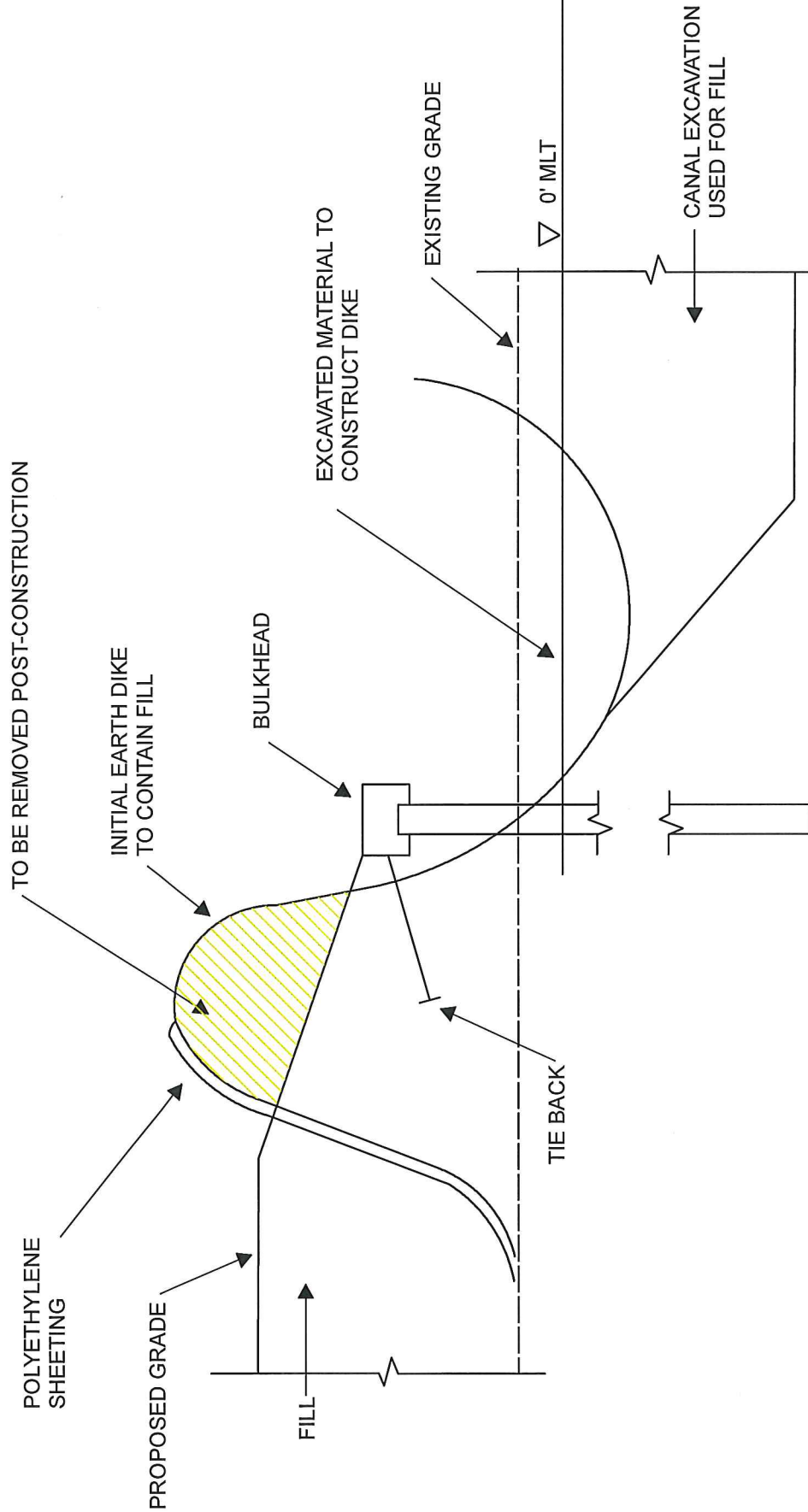

TYPICAL DIKE SECTION

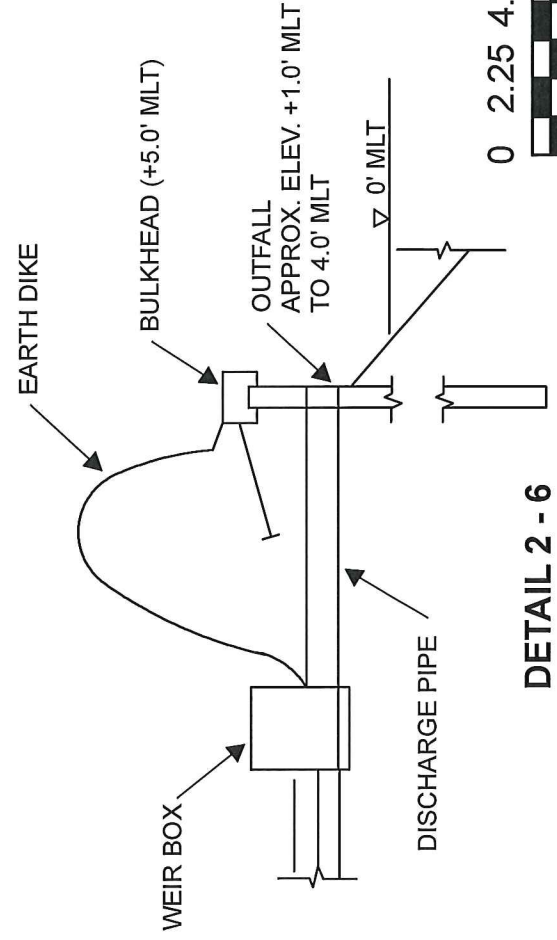
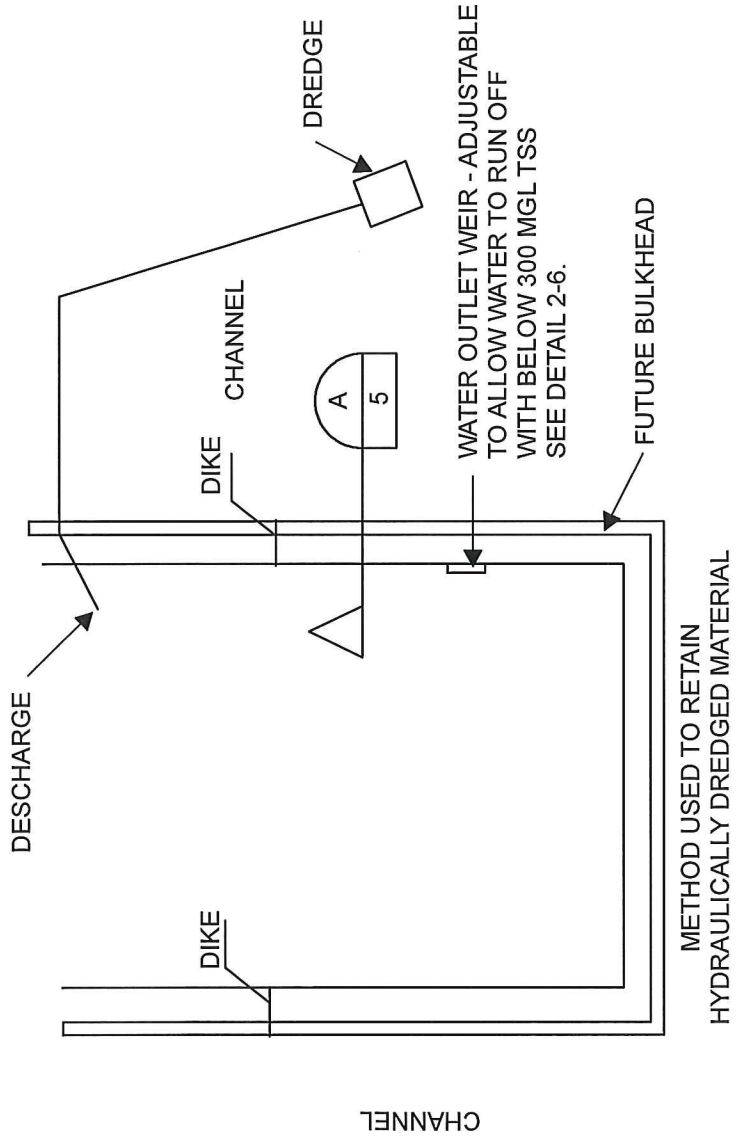

DETAIL 2 - 6
N.T.S.



Conceptual Site Plan

DATE 09-19-19; PROJECT ILLUSTRATIONS BY Urban Engineering

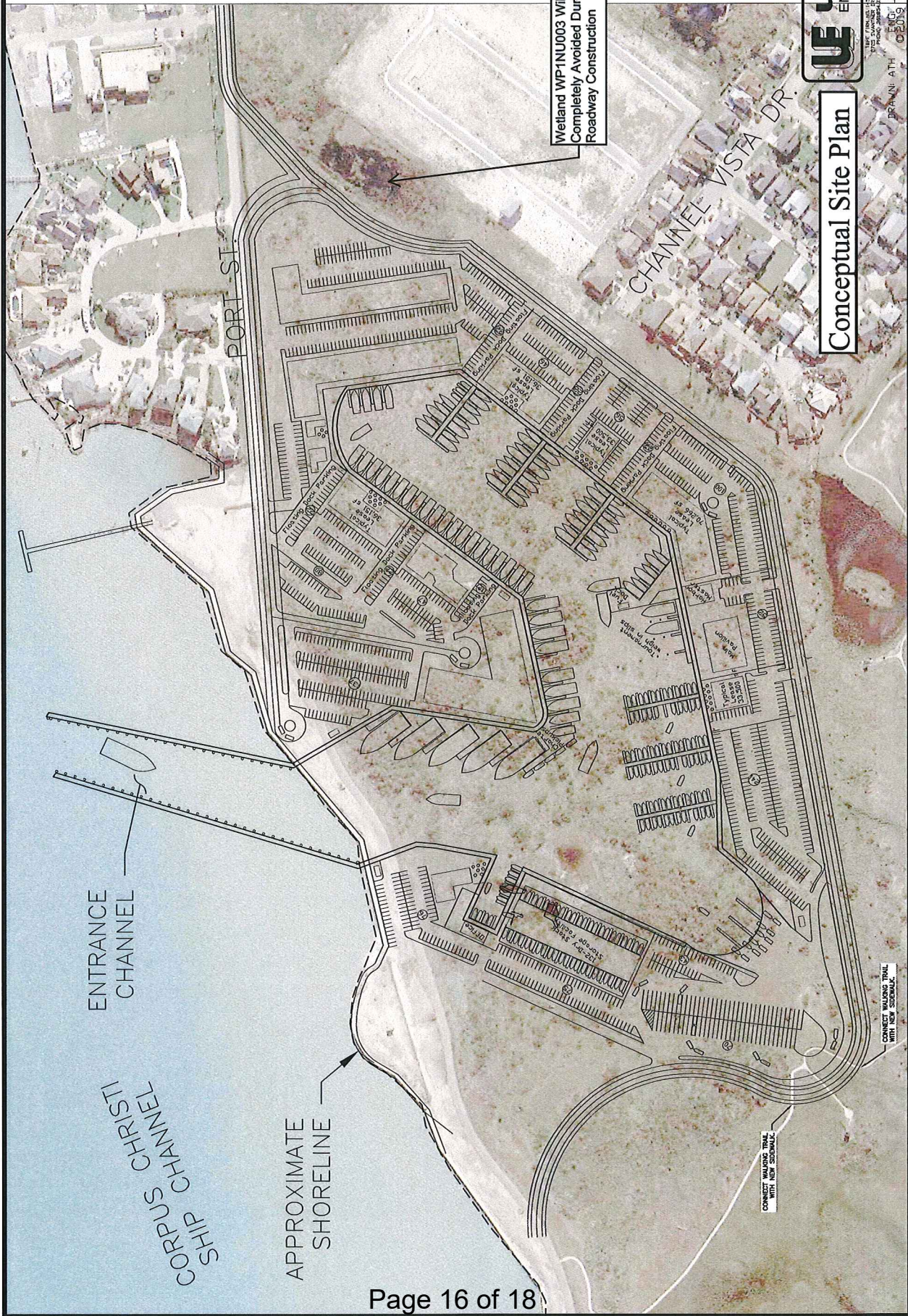

Wetland WP1NU003 Will be Completely Avoided During Roadway Construction

ENTRANCE CHANNEL

CORPUS CRISTI SHIP CHANNEL

APPROXIMATE SHORELINE

CONNECT WALKING TRAIL WITH NEW SIDEWALK

CONNECT WALKING TRAIL WITH NEW SIDEWALK

TOP OF PILE, EL. (+) 7.0'-10.0' NAVD 88

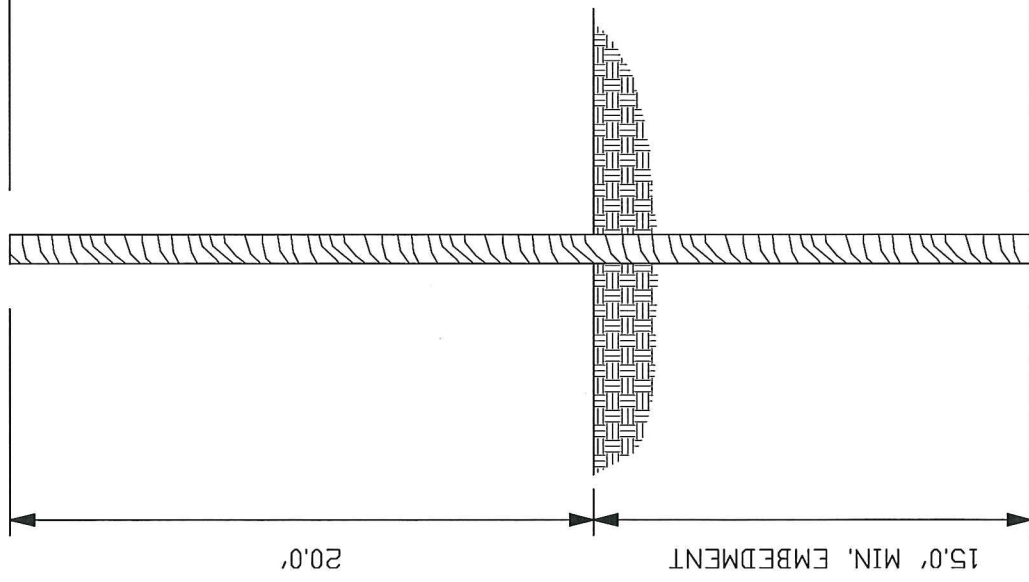

BOTTOM, EL. (-) 10.0'-13.0'

BOTTOM OF PILE, EL. (-) 25.0'-28.0'

- DESIGN CRITERIA:**
- Maximum Wind Speed Occupied - 95 MPH (ASCE 7-10: 3 second gust)
 - Maximum Wind Speed Unoccupied - 130 MPH (ASCE 7-10: 3 second gust)
 - Top of Pile Elevation - (+) 7.0-10.0
 - Existing Bottom Depth - (-) 10.0-13.0
 - Pile Type - 12" Diameter Timber Piling
 - Layout of Piling - As shown on attached layout
 - Number of 12" Piling - (Total - 440 each)
 - Length of Piling - 35 feet
 - Depth of Minimum Required Penetration - 15 feet

12' TIMBER PILING
SCALE: N.T.S.



DATE 09-13-19; EING: JLU; DRAWN: ATH; 2019 by Urban Engineering

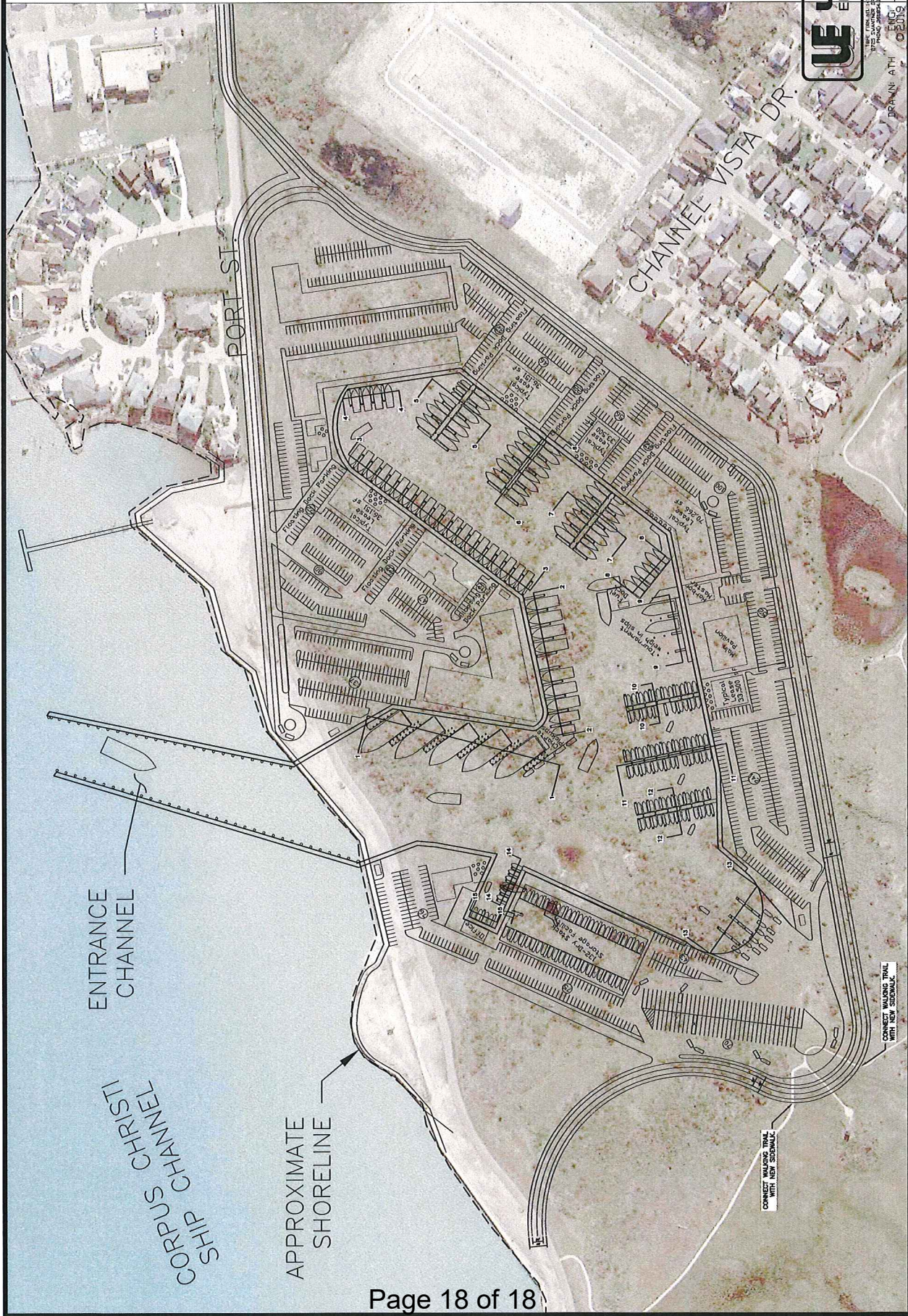

ENTRANCE CHANNEL

CORPUS CRISTI SHIP CHANNEL

APPROXIMATE SHORELINE

CHANNEL VISTA DR.

PORT ST

CONNECT WALKING TRAIL WITH NEXT SECTION

CONNECT WALKING TRAIL WITH NEXT SECTION